

Legend

- Single family 90'+ wide lots
- Single family 80'+ wide lots
- Single family 70'+ wide lots
- Single family 60'+ wide lots
- Zero lotline single family homes 50'+ wide lots
- Stormwater Management/ Community Land
- Proposed roadways
- Association property
- Wetlands

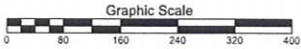

"The Cottages at Hidden Creek"

All of Lot 54, 55, Outlot 3 & the vacated Hidden Winds Lane, and parts of Lots 47, 48, 49, Outlot 4, & vacated Hidden Creek Trail, all being in the recorded plat of "Hidden Creek" (Volume 22, Plats, page 295, Document Number 2255138, Brown County Records), and also Lot 2, Volume 31, Certified Survey Maps, page 339, Map Number 4912, Document Number 1442619, Brown County Records. Part of Lot 290, "Fort Howard Military Reserve", all being located in parts of Lots 288 and 290 of the "Fort Howard Military Reserve", all being in the Village of Howard, Brown County, Wisconsin.

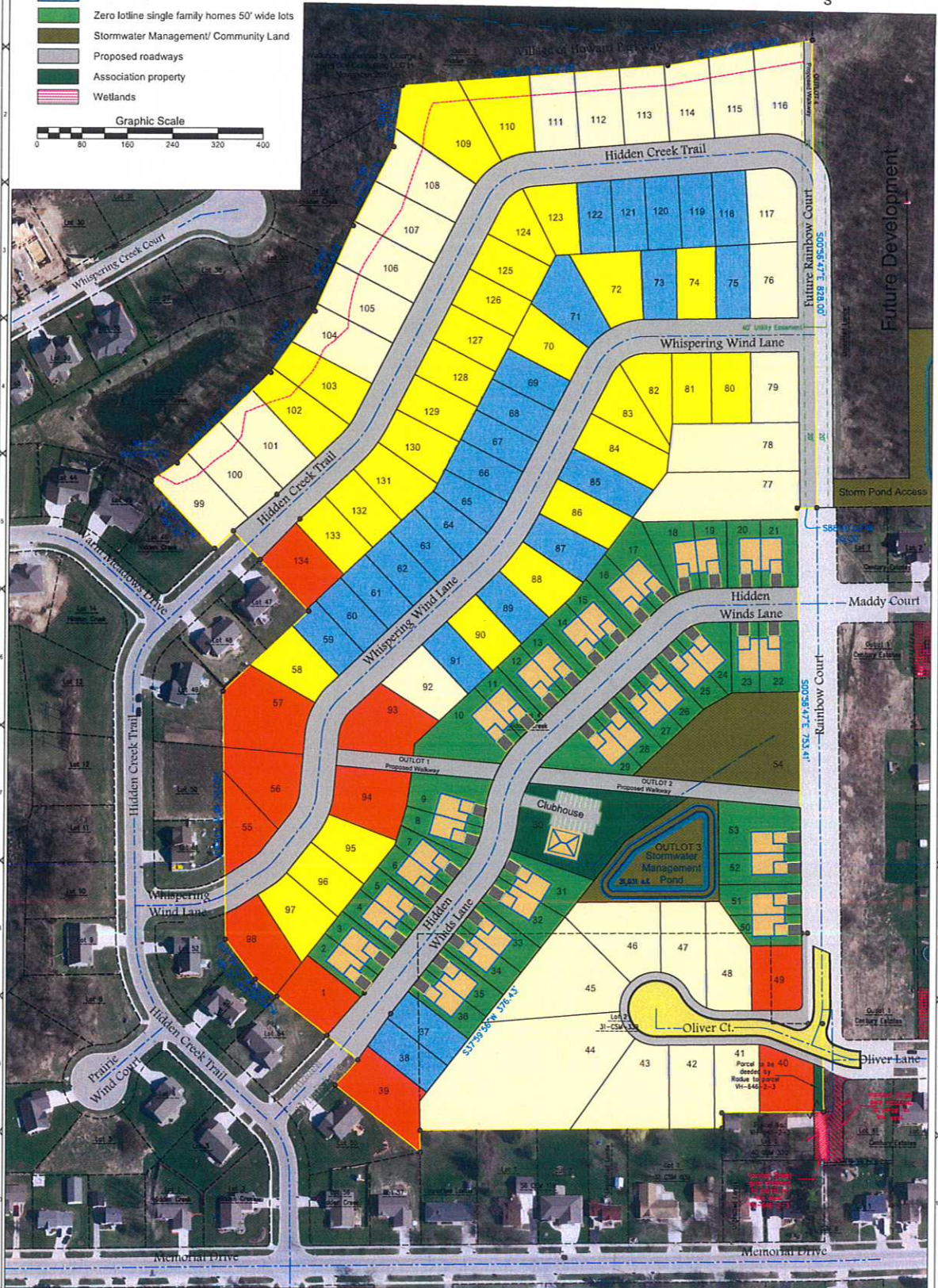
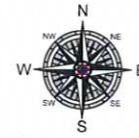

DRAWING NO.
S-2712

Radue Homes, Inc

Mau & Associates
LAND SURVEYING & PLANNING
CIVIL & WATER RESOURCE ENGINEERING
Phone: 920-434-9670 Fax: 920-434-9672

Planned Unit Development

SCALE
1"=80'

TAX PARCEL NO. V43131 V43130 V44462-4 & V44462-5

FILE: 1-1872796 Plan Radue 1228-18.dwg